



Instructions

FORD BRONCO - 2 DOOR UPPER SIDE MOLLE PANELS

Thank you for purchasing your 2 Door Upper Side MOLLE Panels from AAL! We greatly appreciate your trust in our company. We take that purchase and your commitment to us very seriously. If you have any questions along the way, please don't hesitate to give us a call at 385.202.4188.

****These instructions apply to both the upper and lower MOLLE Panels****

****If you purchased just one of the two, skip to that section****

Tools Required:

- M4 Allen Socket/Wrench

What's included:

- Driver Main Panel
- Driver Connection Bracket
- Passenger Main Panel
- Passenger Connection Bracket

Hardware

M6x14mm Button Head Flange Bolts 4



M6 Nylon Lock Nuts 4



Driver Side MOLLE Parts:

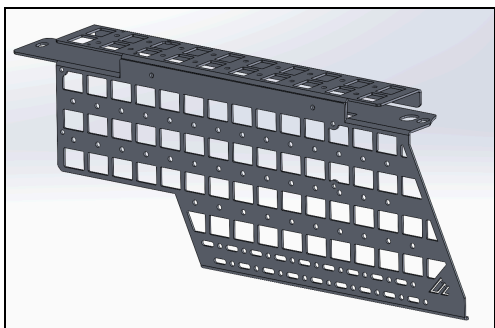

Driver Upper Panel (1):

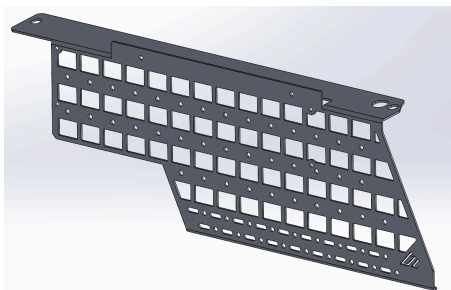

Driver Connection Bracket (1):

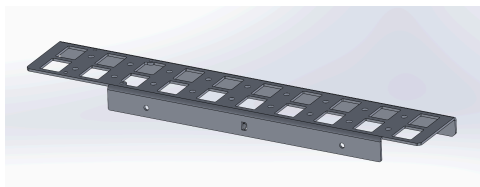

Passenger Side MOLLE Parts:

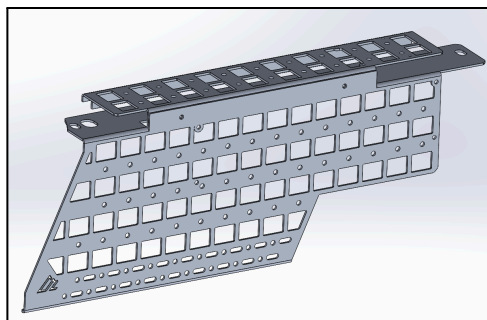

Passenger Upper Panel (1):

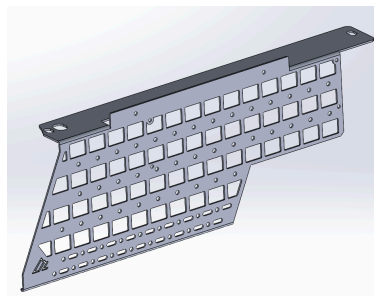

Passenger Connection Bracket (1):

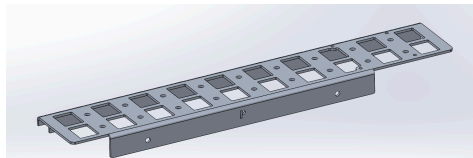

Step 1 - Assemble the Connection Bracket

NOTE: assembly for the driver and passenger side are identical, this instruction sheet will use the passenger side as an example.

The assembly begins by fastening the Connection Bracket to the Main panel on each side. Do this using (2) M6x14mm Button Head Bolts and (2) M6 Nylon Nuts per side. Make sure to insert the bolt from the side and place the nut on the top to make sure you have enough room to tighten them down.

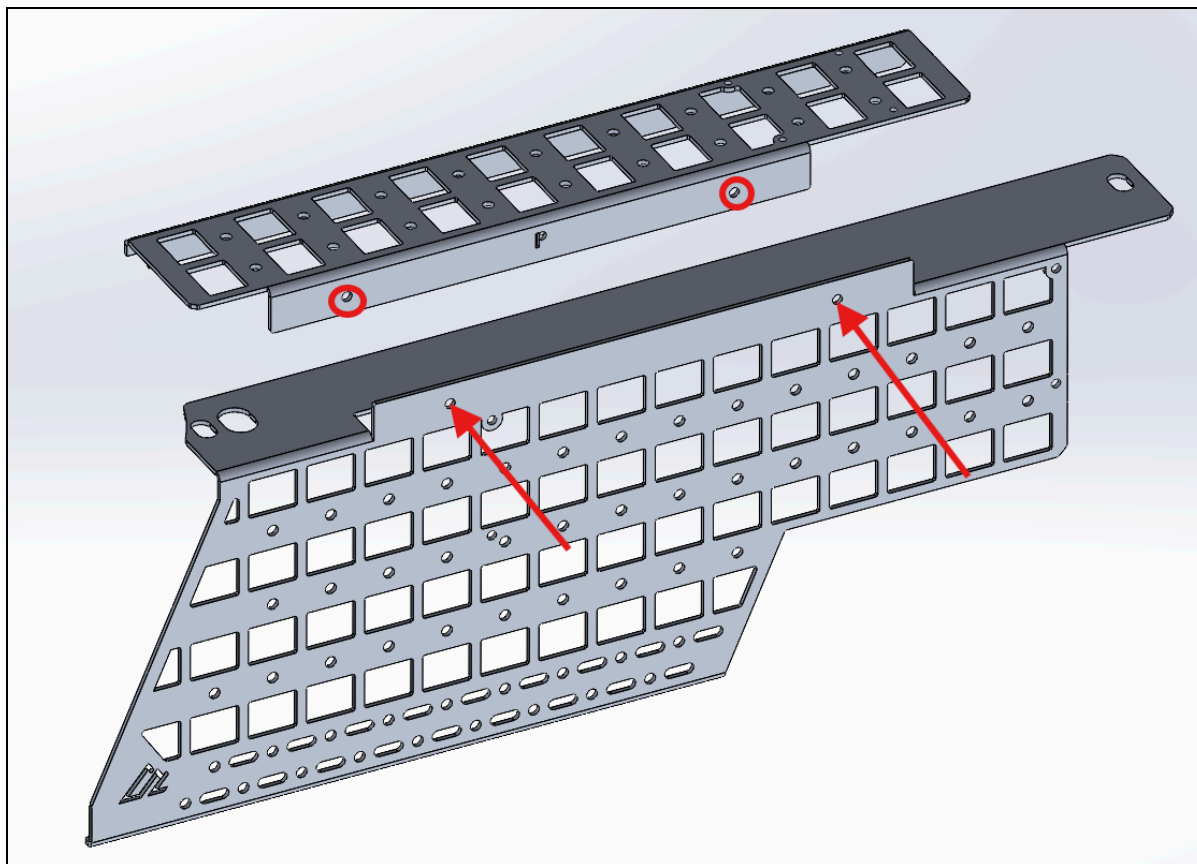

Once the connection bracket is secured, we can now attach the fixture to the vehicle using the (2) factory bolts on the hardtop of the window sill

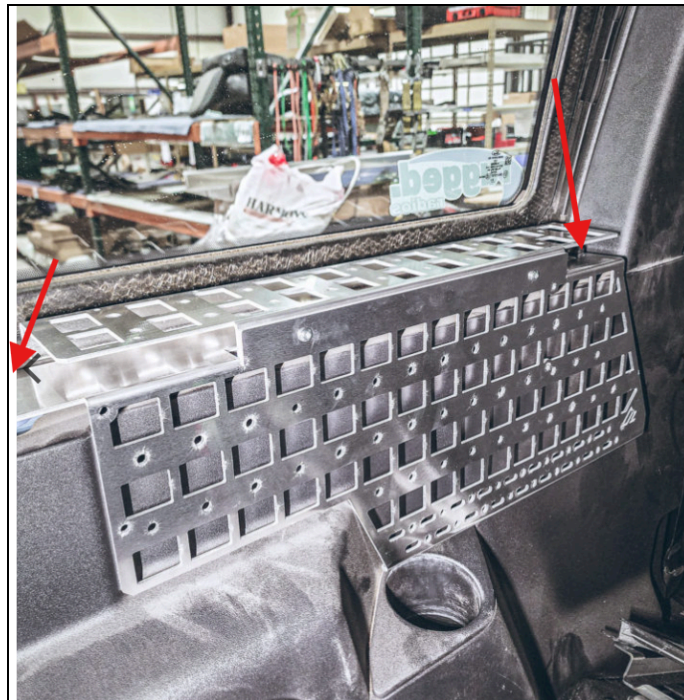
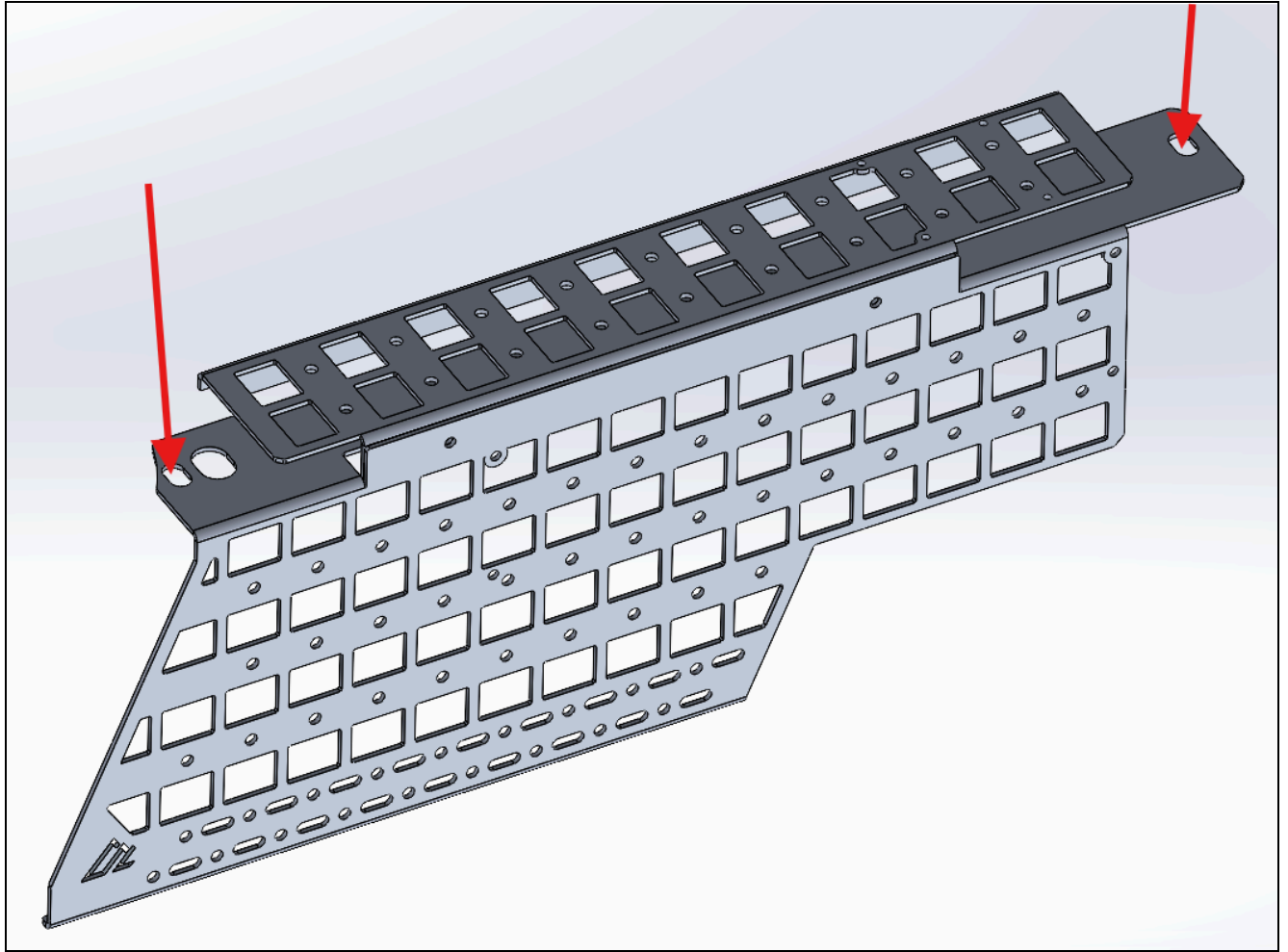

Share Your Photos!

We take great pride in building our products and we hope that pride extends to you after installing your 2 Door Upper Side MOLLE Panels. If you are able to share your photos online (Facebook and Instagram), please tag **@AmericanAdventureLab**. We would love to see how it turned out and give you some reciprocal attention in return!

Congrats! You're all done!

Thank you!

At American Adventure Lab, we strive to improve anywhere we can. If you experience any issues with this product or have any suggestions, please let us know.

If you have any questions or concerns, please don't hesitate to reach out to us at 385.202.4188 or via email at Support@erp.adventurelab.com.

